

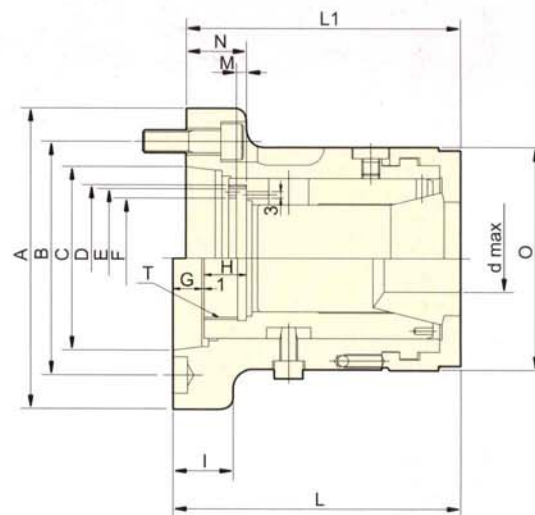

## Power Operated Collet Chucks

# CL-Series



### DIMANSIONS :

Din Type	Max r.p.m.	Steel collet	Rubber collet	A	B	C	D	E	F	G MIN	G MAX	H	I	L	L1	M	N	O	d MAX	T
CL30-A4-S	7000	163E	Series 24	112	82.6	63.5	M50 XP1.5	45	35	-	-	-	30	-	110	4	21	85	30	
CL30-A4-4	7000	163E	Series 24	112	82.6	63.5	-	-	-	6	15.5	14	30	116	-	-	-	85	30	M40 xP1.5
CL42-A5-S	6000	173E	Series 36	135	104.8	82.5	M66 XP1.5	62.5	54	-	-	-	27	-	123	4.5	27	100	42	
CL42-A5-5	6000	173E	Series 36	135	104.8	82.5	-	-	-	5.5	16.5	19	27	129	-	-	-	100	42	M55 xP2.0
CL42-A6-S	6000	173E	Series 36	170	133.4	106.4	M66 XP1.5	62.5	54	-	-	-	32	-	123	4.5	27	100	42	
CL42-A6-6	6000	173E	Series 36	170	133.4	106.4	-	-	-	6	17	21	32	132	-	-	-	100	42	M60 xP2.0
CL60-A6-S	5000	185E	Series 52	170	133.4	106.4	M90 XP1.5	86.5	78	-	-	-	27	-	145	4.5	27	130	60	
CL60-A6-6	5000	185E	Series 52	170	133.4	106.4	-	-	-	17	28	14.5	27	155	-	-	-	130	52	M60 xP2.0
CL60-A8-S	5000	185E	Series 52	220	171.4	139.7	M90 XP1.5	86.5	78	-	-	-	37	-	155	4.5	27	130	60	
CL60-A8-8	5000	185E	Series 52	220	171.4	139.7	-	-	-	17	28	13.5	37	155	-	-	-	130	60	M85 xP2.0
CL80-A8-S	4000	193E		220	171.4	139.7	M114 XP2.0	107	99	-	-	-	35	-	176.5	6	31	156	80	

• Uses Steel and Rubber collets to DIN 6343